



425-6190

'07-'11 Ford Expedition Installation Instructions



Tools Needed:
Flathead Screwdriver
7mm Nutdriver
1/4" Drive Handle
1/4" Drive Extension (4" and 6")
1/4" Drive Ratchet
7/32", 5/16", 7/16", 1/4" Drive Sockets
Long Phillips Screwdriver



1

Remove chrome bezel around gear shift. Gently pry up with flathead screwdriver and remove.



2

Pull out rubber tray and set aside.



3

Use 7mm nutdriver to remove screw in console.

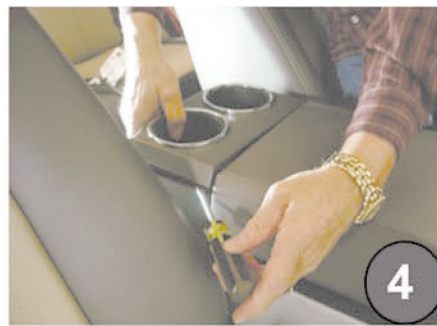

4

Gently pry up and remove cup holders in console using flathead screwdriver, set aside.



5

Use phillips screwdriver to remove (4) screws in the back of console to remove arm rest.



Remove arm rest.



Remove 7mm screws on top of console.



Use 7/32" socket to remove (2) rear screws.



Gently pry out rear console housing...



...and set aside.



Gently pry up on cupholder assembly.



Remove and set aside.



Gently pry up upper glove box housing and set aside.



Remove 7mm screws (two in front and two in back)

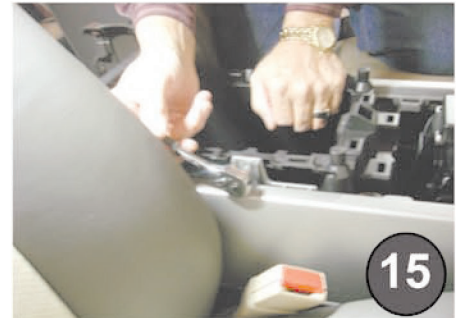

15

Remove screws on side of glove box housing using a 7/32" socket (two on each side).



16

Remove the caps covering (2) 5/16" bolts located at the bottom front and rear of the right and left side panels. Use 5/16" socket to remove the bolts.



17

Remove side panels.



18

Remove side panels.



19

Remove (6) 7mm screws, holding glove box inner housing, and set aside.

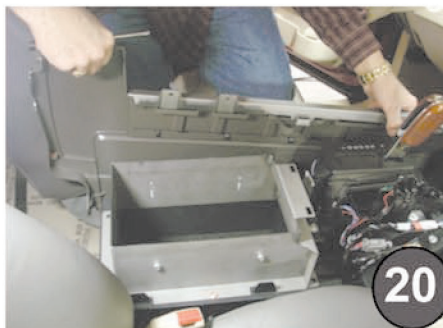

20

Insert the new console housing using (6) factory 7mm screws...



21

...and re-install side panels.



Replace (2) screws on each side of panels, using phillips screwdriver.



Re-install rear of console.



Install new console, secure (4) bolts then replace rear cupholder, front cupholder and gear shift bezel.



Replace the 5/16" bolts (two on left side and two on right side of the console side panels and the covers).



Install complete.

