



425-6271 2012+ FORD F250-F550 INSTALLATION INSTRUCTIONS



Remove panel below steering column. Gently pry up from the bottom.



Use a flat head screwdriver to remove the left and right corners of the dash.



Unplug the components from the corner panels.

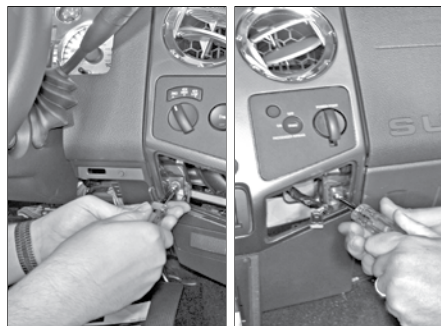

Remove the screws from the left and right side behind the corner panels.



Gently pull the panel off of the dash.



Unplug the components from the panel.

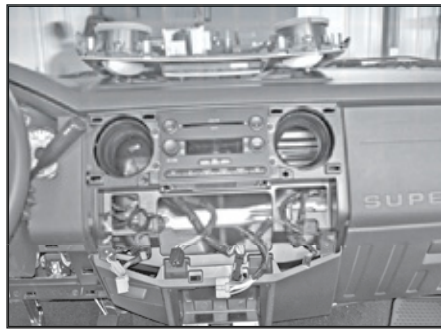

Set the panel aside.

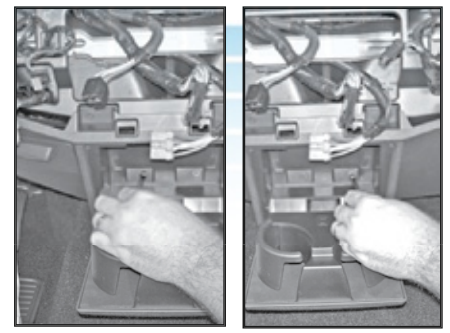

Lower the cup holder and remove the 2 screws.

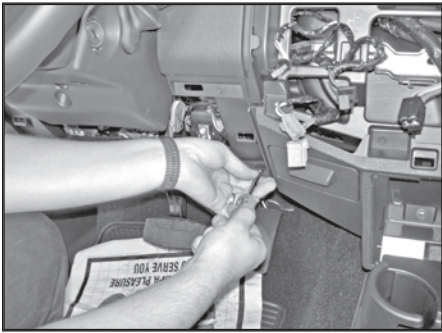

Remove the screw from the left side of the panel.

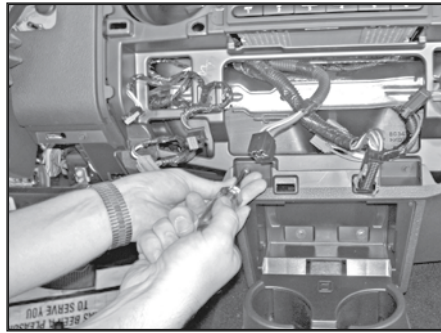

Remove the two center screws on the panel.

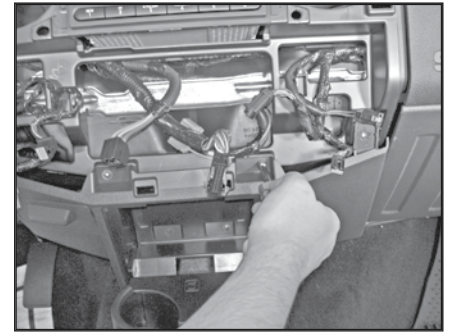

Gently pry the lower panel off and remove and set aside.

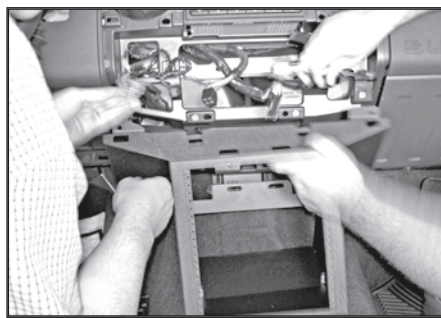

Line up Contour Console with holes on dash.

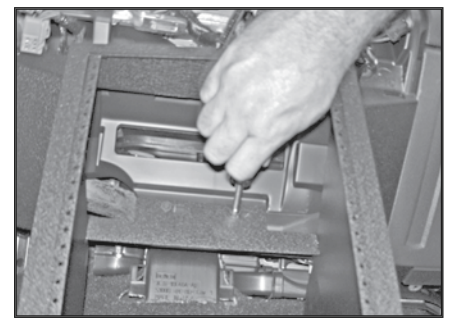

Place the two screws back into lower center holes.(but do not tighten down)

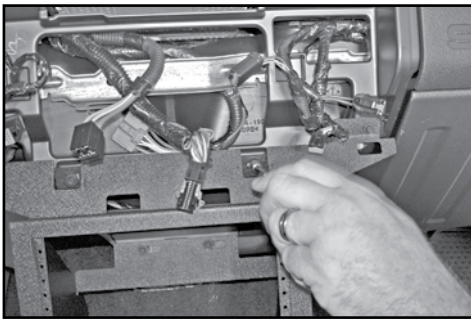

Replace 2 screws into upper center holes. (but do not tighten down)

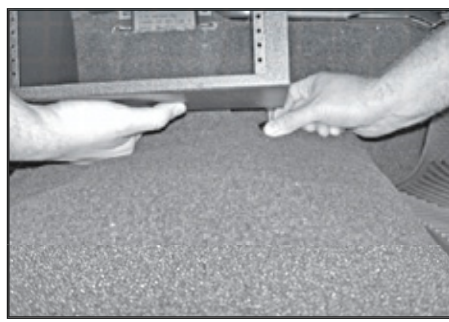

Adjust levelers to secure console into place.

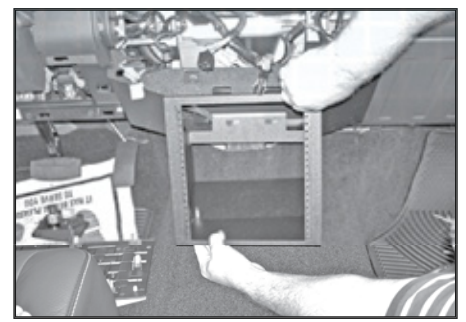

As levelers are adjusted shift console into place. Be sure outer holes line up (see pic. 18) Now tighten down all four screws from step 14 and 15.

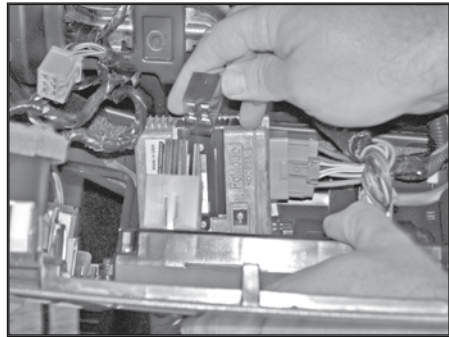
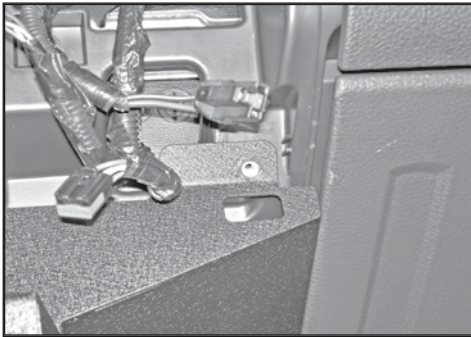

Replace all connectors into the upper panel.



Replace upper panel making sure that the three connectors for the lower corner panels are threaded back through.



Place the upper panel back on to the dash.



Replace the 2 screws located behind the 2 corner panels.

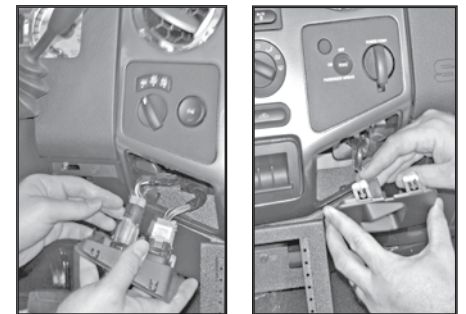

Reconnect the components to the small corner panels.

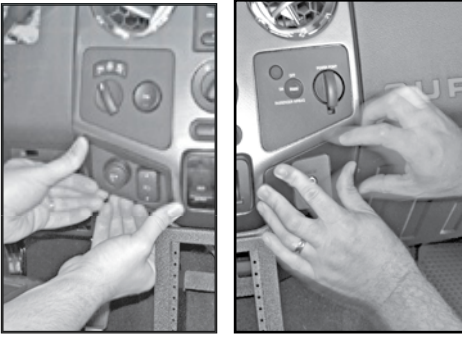

Replace the bottom corner panels.



Replace the screw on the left side of the console and replace the panel under the steering column.

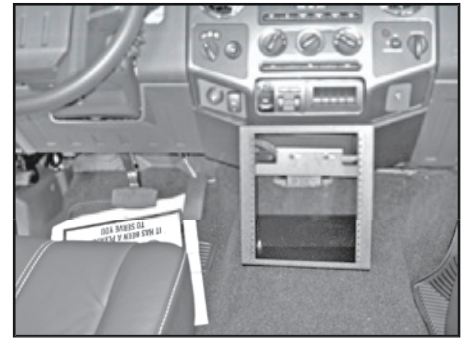

CONGRATULATIONS!!!
Your install is now complete and ready for faceplate and equipment mounting...



PUBLIC SAFETY SOURCE
WWW.PUBLICSAFETYSOURCE.COM
1-866-587-4661



DIVERSIFIED
PRODUCTS.NET